

Quick Start Guide

Q23T SERIES

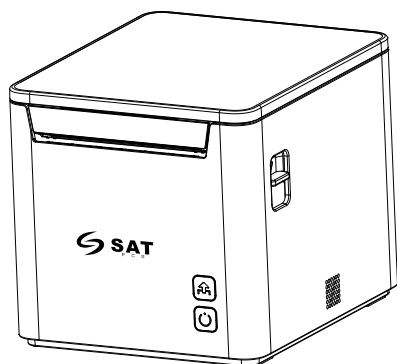

Technical Assistance

Packing List



Printer

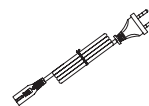

Power Cord



Quick Start Guide

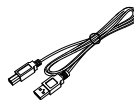

USB Cable

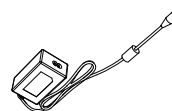

Power Adapter

⚠ Notes:

1. The items in the package are dependent on the actual order.
2. Follow the link <https://satpcs.com/descargas> and find the product name Q23T, then you can download User Manual, Windows Drivers and other items.

Caution: This is a Class A product. In a domestic environment this product may cause radio interference in which the user may be required to take adequate measures.

Appearance and Components

■ Front & Side View

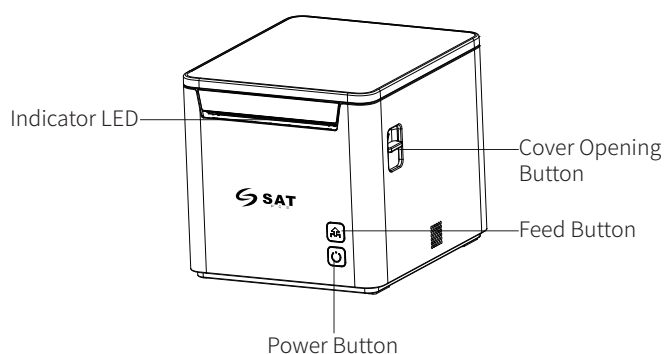

■ Back View

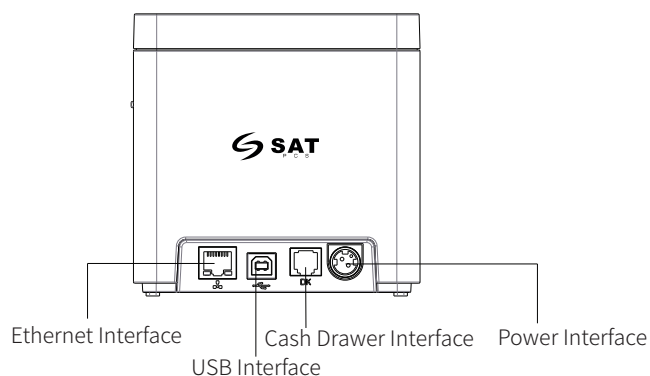

⚠ Note: Wi-Fi and Bluetooth interfaces are embedded in the printer optionally.

Paper Loading

1. Press the cover opening button to open the top cover.
2. Load the roll paper in the correct direction.

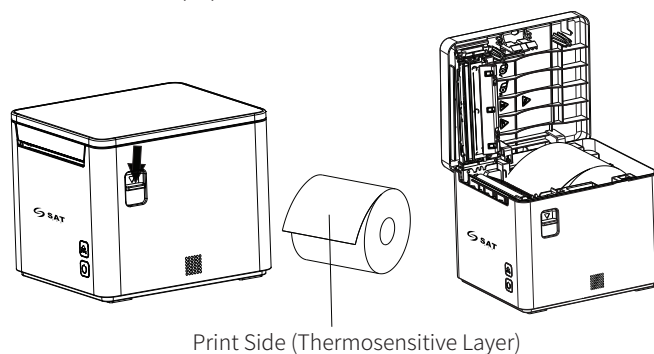

3. Pull out some paper, and close the printer cover.
4. Tear the extra paper.

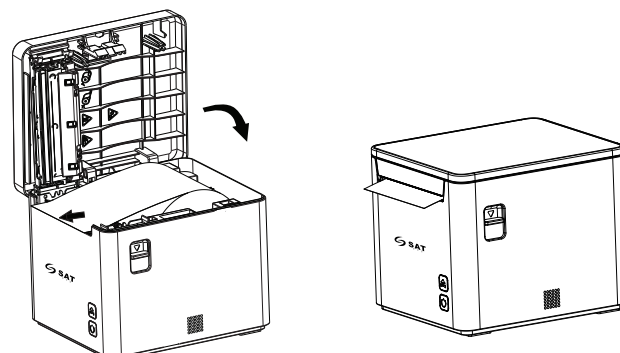

Power Supply

- 1. Make sure the printer is turned off.
- 2. Connect the power adapter to the printer.
- 3. Connect the power adapter to the power cord.
- 4. Plug the other side of the power cord into the socket outlet.

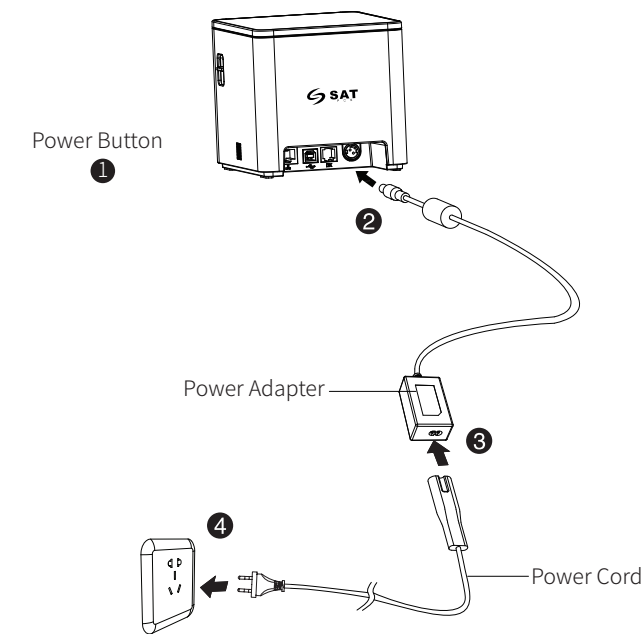

Notes:
1) The power adapter and power cord vary by country or region.
2) Use only the specified voltage. Incorrect voltage damages the printer (refer to the adapter).

CE DECLARATION OF CONFORMITY

Manufacturer certifies that the following designated product:

SAT Q23T Series

Type of product:

Direct Thermal Line Printing

It is in conformity with the standards.

Test Standard Information

Under the Council Directive: (LVD) Directive 2014/35/EU relating to electrical equipment designed for use within Low Voltage Directive.

EN 62368-1:2014+A11:2017

Under the Council Directive: (EMC) Directive 2014/30/EU relating to Electro Magnetic Compatibility.

EN 55032: 2015+AC:2016

EN 55035: 2017

EN 61000-3-2: 2014

EN 61000-3-3: 2013

We declare herewith that as a result of the manner in which the device designated below was designed, the type of construction and the devices which, as a result have been brought on to the general market comply with the relevant fundamental regulations of the CE Rules for Safety. And we declare herewith the above mentioned model is conformity with Directive 2014/30/EU and 2014/35/EU. In the event of any alteration which has not been approved by us being made to any device as designated above, this statement shall thereby be made invalid.

Ethernet/Bluetooth/Wi-Fi Setting

1. Ethernet Settings

Connect the printer to router (or master device) through the network cable;
The default Ethernet mode is default dynamic;
Ethernet interface parameters can be set through POS utility or web (Master device and printer are under the same network segment, enter the IP assigned to in master device browser);
Please refer to User Manual for details.

2. Bluetooth Settings

Default name: BT Printer-xxxx (xxxx is the last four digits of MAC address)

Default password: none
Please refer to User Manual for details.

Note: This setting is only available for models with Bluetooth.

3. Wi-Fi Settings

Printer WiFi factory default is AP mode with IP address "192.168.1.1" and SSID "POS_WIFI-xxxx" (xxxx is the last four digits of MAC address). After the PC or mobile phone is connected with printer successfully, users can do some parameter settings through utility tool.
Please refer to User Manual for details.

Note: This setting is only available for models with Wi-Fi.

FCC Warning

This device complies with part 15 of the FCC Rules. Operation is subject to the following two conditions: (1) this device may not cause harmful interference, and (2) this device must accept any interference received, including interference that may cause undesired operation.

Any changes or modifications not expressly approved by the party responsible for compliance could void the user's authority to operate the equipment.

NOTE: This equipment has been tested and found to comply with the limits for a Class A digital device, pursuant to part 15 of the FCC Rules. These limits are designed to provide reasonable protection against harmful interference when the equipment is operated in a commercial environment. This equipment generates, uses, and can radiate radio frequency energy and, if not installed and used in accordance with the instruction manual, may cause harmful interference to radio communications. Operation of this equipment in a residential area is likely to cause harmful interference in which case the user will be required to correct the interference at his own expense.

- Reorient or relocate the receiving antenna.
- Increase the separation between the equipment and receiver.
- Connect the equipment into an outlet on a circuit different from that to which the receiver is connected.
- Consult the dealer or an experienced radio/TV technician for help.

The device has been evaluated to meet general RF exposure requirement. The device can be used in portable exposure condition without restriction.